

- NOTE:**
- 1) MINIMUM CONCRETE COMPRESSIVE STRENGTH AT 28 DAYS IS 5500PSI
 - 2) 6% AIR ENTRAINMENT
 - 3) 3 LBS STRUCTURAL FIBER PER CUBIC YARD
 - 4) FACING TEXTURE AS SPECIFIED IN THE CONTRACT

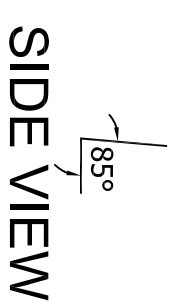
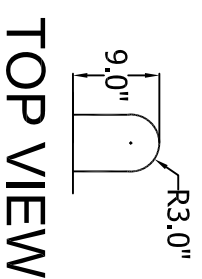
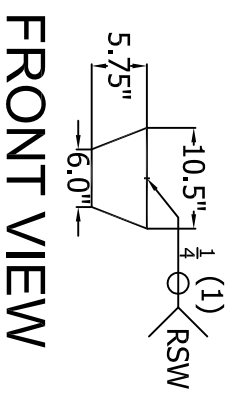

HALF PANEL CONNECTING LOOP DETAIL

NOTE:
 MATERIAL IS 1/4" DIA. T304 115 KSI STAINLESS STEEL WIRE ASTM A580
 ALL DIMENSIONS ARE OUTSIDE TO OUTSIDE INCLUDING RADIUS
 WELDING IN ACCORDANCE WITH AASHTO/AWS D1.5M/D1.5

REV #	DESCRIPTION	DATE

LOGK+LOAD™

RETAINING WALL SYSTEMS
 1881 CHESTNUT STREET, SUITE 400, VANCOUVER, B.C. V6J 4M6
 Tel: (604) 732-9999 Fax: (604) 731-1140
 Web site: www.logk-load.com

PROJECT NAME: HALF WIDE PANEL
 TYPICAL DETAILS

CITY: COQUITON
 DRAWN BY: KJA
 DATE: 01/06/12
 APPROVED BY: RC/DA
 SCALE: N.T.S.
 OUR PROJECT NUMBER: LL-WSDOT-1D-HALF PANEL
 OUR DRAWING NUMBER: LL-WSDOT-1D-HALF PANEL